

Policy Unit 5A19 Southmoor Lane to Farlington Marshes		
Summary description of Policy Unit		
<p>This frontage is backed along much of its length by the regionally important A27 and rail networks. Within the relatively extensive tidal floodplain, there is mixed development with residential and commercial properties, community facilities, commercial, agricultural grade 1 land. There is also a strategically important sewage treatment plant at Budd's Farm, and a former landfill site. Existing defences are owned and maintained by the Local Authority and the Highways Authority. Analysis of shoreline erosion (see Appendix C5) indicates the rate and scale of coastal processes are less within the harbours than on the open coast. The inter-tidal habitats are of International, European and national nature conservation importance; fields provide feeding sites for Brent Geese, and support the adjacent and nearby SPA/Ramsar sites. There is an RSPB reserve south of this frontage within Langstone harbour. This frontage has been assessed in the emerging Portchester to Emsworth Coastal Defence Strategy.</p>		
Final policy options		SMP1 Ref n/a
Epoch 1 From Present Day (up to 2025)	Epoch 2 Medium Term (2025 to 2055)	Epoch 3 Long Term (2055 to 2105)
Hold the Line	Hold the Line	Hold the Line
Summary of rationale behind final policy options		
<p>The final policy options are consistent with the emerging Portchester Castle to Emsworth Coastal Defence Strategy. Continued maintenance of the current defence line will provide flood risk management to regionally important A27 and railway lines, the strategically important sewage treatment plant at Budd's Farm, the residential and commercial centre of Langstone with its community facilities, heritage features and cross-harbour infrastructure. However maintenance and improvements to defence line is unlikely to provide long term protection to the former landfill site due to rising ground and sea water levels. Offshore within Langstone Harbour, the saltmarsh islands and sandflats that function as roost sites will become increasingly vulnerable to rising sea levels.</p> <p>Due to the environmental designations within Langstone Harbour holding the defence line will continue to contribute towards the loss of European and national nature conservation designated habitats such as inter-tidal foreshore habitats, through coastal squeeze. These losses will need to be mitigated within the same designated area or compensated for elsewhere and delivered through the Regional Habitat Creation Programme. Opportunities for habitat mitigation and compensation have been detailed within the Appropriate Assessment of the final policies.</p>		
Policy changes through Public Consultation		
None		

Funding

It is uncertain whether central government funding would be secured for identified works, as determined through the emerging Portchester to Emsworth Coastal Defence Strategy. Alternative sources of public funding may be available to Local Authority. As is currently the case, no public funding would be available for continued maintenance of defences by private owners.

Further Studies (identified in Action Plan)

Conclusion and approval of Portchester to Emsworth Coastal Defence Strategy
Solent-wide network of high tide roost site study

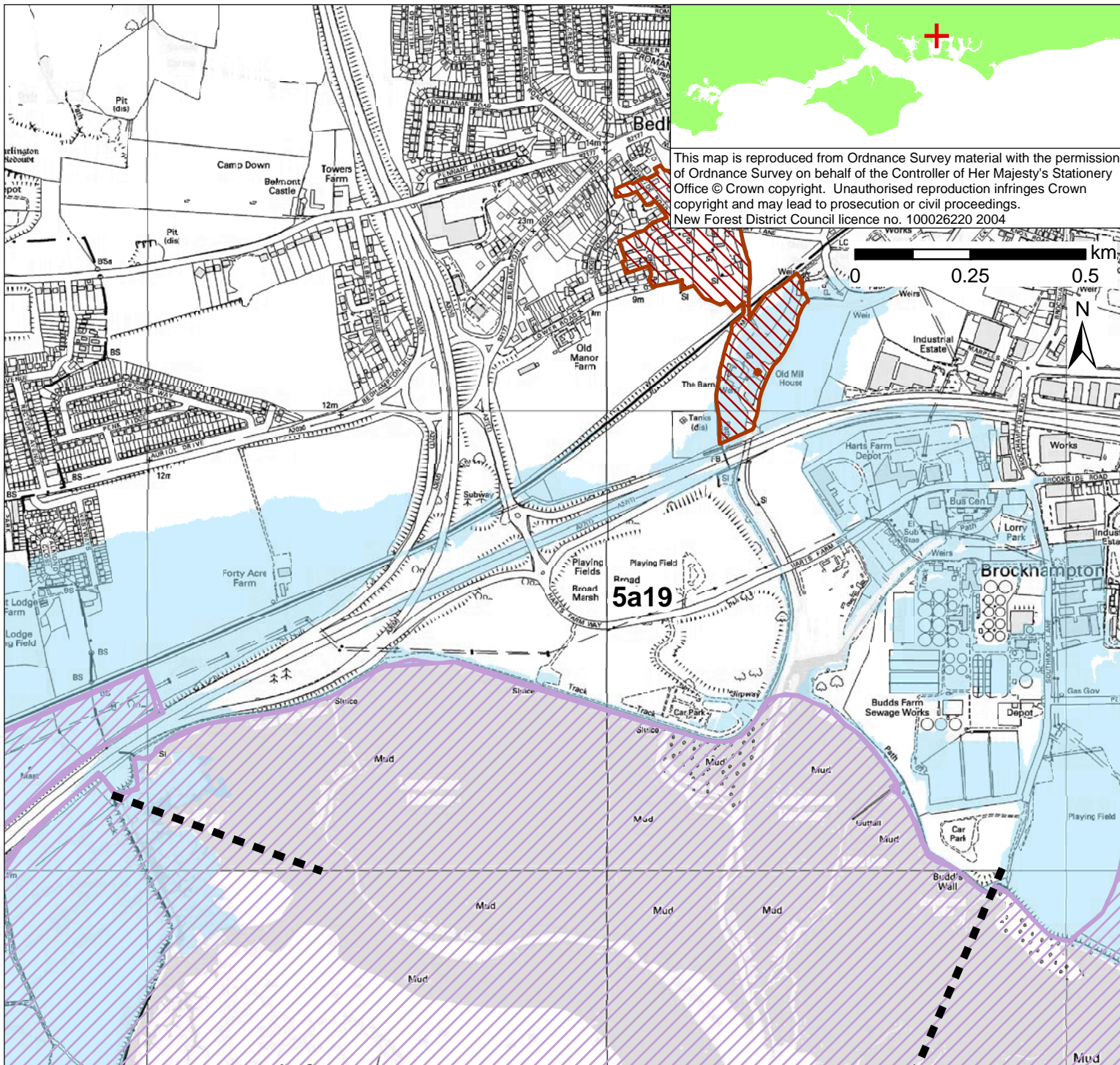

This map is reproduced from Ordnance Survey material with the permission of Ordnance Survey on behalf of the Controller of Her Majesty's Stationery Office © Crown copyright. Unauthorised reproduction infringes Crown copyright and may lead to prosecution or civil proceedings. New Forest District Council licence no. 100026220 2004

POLICY

From Present Day (up to 2025):	Medium-Term (2025 to 2055):	Long-Term (2055 to 2105):
Hold the Line	Hold the Line	Hold the Line

- Indicative erosion zone up to 2025
- Indicative erosion zone up to 2055
- Indicative erosion zone up to 2105
- Policy Unit Boundary
- International / National Designations
- Important Heritage Sites
- 2115 Indicative Floodplain (1 in 200 year) provided from PUSH